

ASSEMBLY - ORIGINAL & MINI RAIL SYSTEM

* Same steps apply for both Double Rail Systems and Triple Rail Systems.

* Compatible with hybrid tumblers.

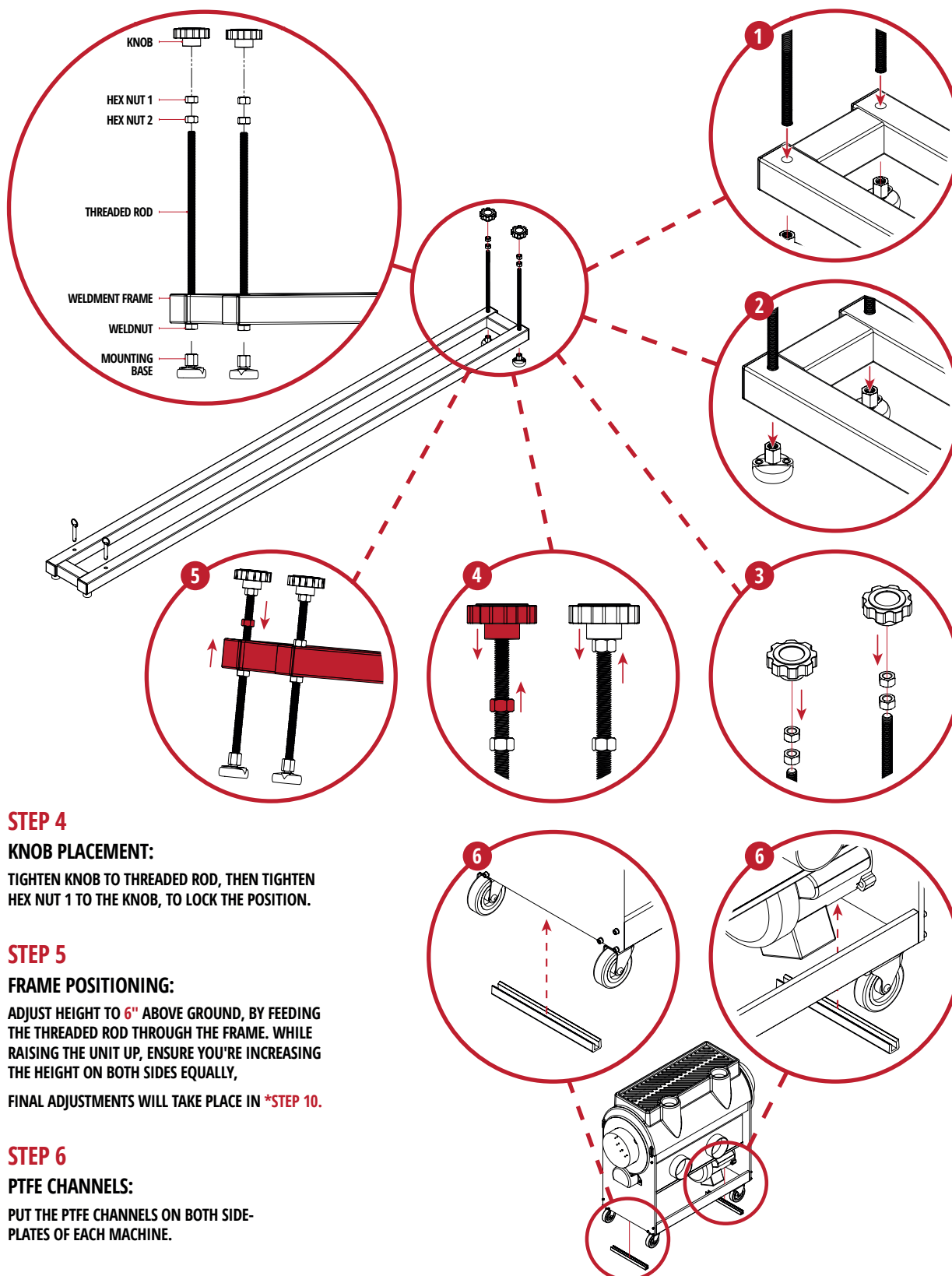

STEP 1

THREADED ROD POSITIONING:

FEED THE THREADED ROD INTO THE WELD NUT IN THE DIRECTION AS THE FIGURE ILLUSTRATES.

STEP 2

MOUNTING BASE:

CONNECT THE MOUNTING BASE TO THE THREADED ROD, ON THE BOTTOM SIDE OF THE FRAME.

STEP 3

HEX NUT:

THREAD HEX NUT 1, HEX NUT 2, AND KNOB ON THE OTHER SIDE OF THE THREADED ROD.

STEP 4

KNOB PLACEMENT:

TIGHTEN KNOB TO THREADED ROD, THEN TIGHTEN HEX NUT 1 TO THE KNOB, TO LOCK THE POSITION.

STEP 5

FRAME POSITIONING:

ADJUST HEIGHT TO 6" ABOVE GROUND, BY FEEDING THE THREADED ROD THROUGH THE FRAME. WHILE RAISING THE UNIT UP, ENSURE YOU'RE INCREASING THE HEIGHT ON BOTH SIDES EQUALLY,

FINAL ADJUSTMENTS WILL TAKE PLACE IN *STEP 10.

STEP 6

PTFE CHANNELS:

PUT THE PTFE CHANNELS ON BOTH SIDE-PLATES OF EACH MACHINE.

**LEARN
HOW NOW**



ASSEMBLY - ORIGINAL & MINI RAIL SYSTEM

STEP 7

MACHINE POSITIONING:

SLIDE THE MACHINES, FRONT-TO-BACK, ONE BY ONE, OVER THE RAIL. KEEP THE MACHINES ALIGNMENT CENTERED TO THE WELDMENT FRAME.

STEP 8

STOPPING PINS:

INSERT STOPPING PINS TO PREVENT MACHINES FROM SLIDING DOWN.

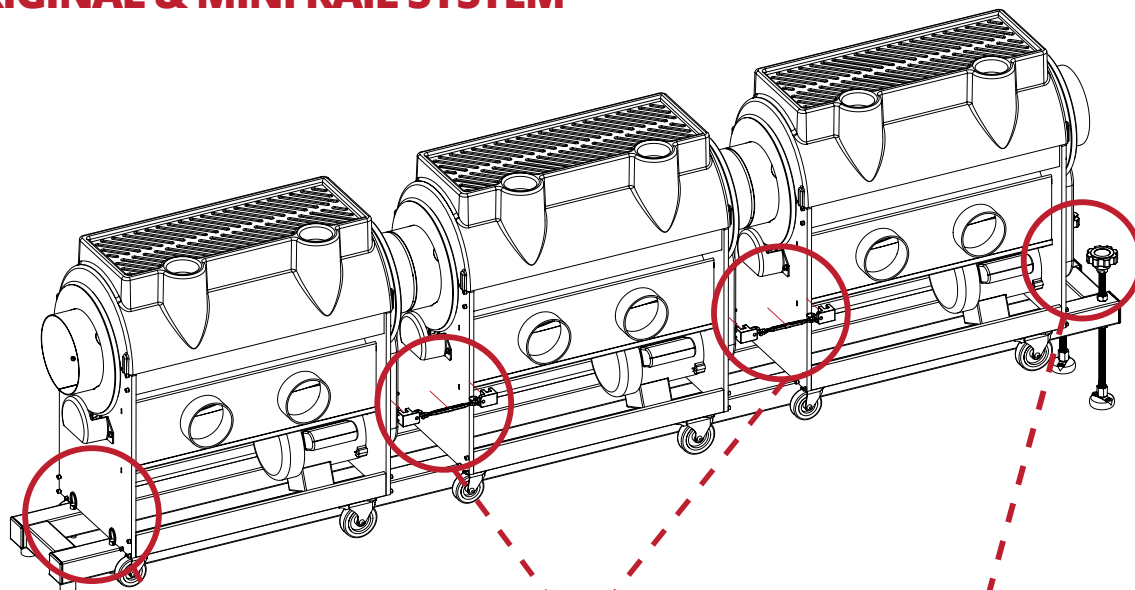

STEP 9

TURNBUCKLE ADJUSTMENT:

USE TURNBUCKLES TO LINK CONNECTORS ON BOTH SIDES. USE PIN TO LOCK TOGETHER. SLIDE CLAMPS OVER FRONT AND BACK PLATES. TIGHTEN SET SCREWS TO KEEP IN PLACE. ADJUST GAP BETWEEN TWO MACHINES TO 0.25" BY TURNING TURNBUCKLES.

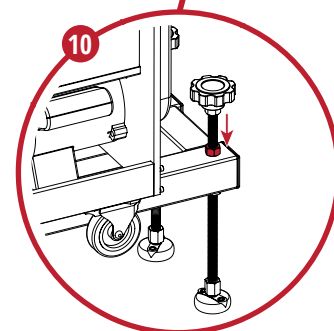
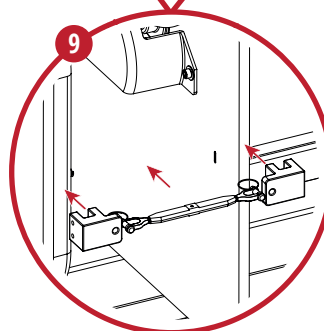
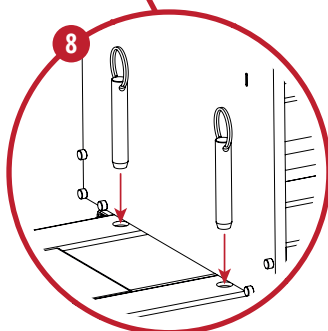

STEP 10

MACHINE POSITIONING:

HELP GUIDE MACHINES INTO FINAL LOCATION. MAKE SURE ALL MACHINES ARE LIFTED OFF THE GROUND. TIGHTEN HEX NUT 2 TO THE WELDMENT FRAME TO LOCK IN POSITION.

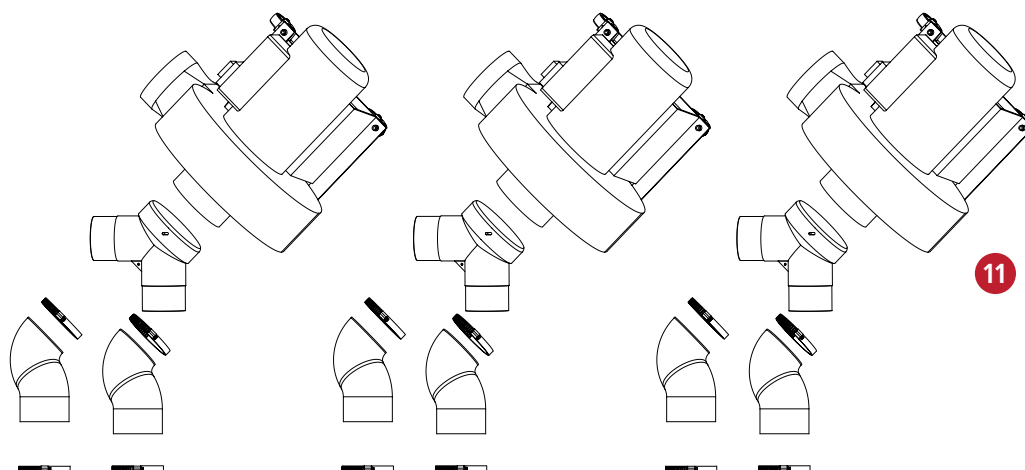

STEP 11

BLOWER INSTALLATION:

USE HOSES AND CLAMPS TO CONNECT BLOWERS TO EACH UNIT.

